

# Step Drill Bits



Trust IDEAL step drill bits for precise, repetitive drilling through the toughest materials including brass, carbon steel, cast iron, stainless steel, and more. These tough and reliable tools are constructed with a rugged titanium nitrite exterior coating. Each step is gradually blended to ease stepping through hole sizes; reducing the need to keep changing drill bits, which speeds up the fabrication process. Improved Split-Point tip design eliminates the need for a starter hole or punch and delivers three times faster starts, saving valuable time. The double-fluted design provides balanced cuts and cooler operation.



STEP DRILL BITS

Drill Diameter Sizes (In.)	No. of Hole Sizes	Step Increments (In.)	Step Thickness (In.)	Shank Dia. (In.)	Cat. No.
1/8 to 1/2	13	1/32	1/8	1/4	35-511
1/4 to 3/4	9	1/16	1/8	3/8	35-512
1/4 to 7/8	11	1/16	1/16	3/8	35-513
1/2 to 1	8	1/16	1/8	3/8	35-514*
1/4 to 1-1/8	16	1/16	1/16	3/8	35-515
3/16 to 1/2	6	1/16	3/8	1/4	35-516
1/4 to 1-3/8	10	1/32	1/16 to 1/4	3/8	35-517

\*Requires pilot holes.

## Electricians Step Bit Kit

- Durable blow-molded case securely holds and protects bits
- Includes four step bits (35-511, 35-513, 35-515 and 35-517)
- Kit provides a solution for every electrical hole size between 1/8 in. and 1-3/8 in.



Description	Cat. No.
Electrician's Step Bit Kit	35-520

## Quick Change Step Bits



- Split-Point tip lasts longer and starts faster than competition
- High speed tool steel
- Double-tempered for superior tip life
- Double fluted and blended radius steps for smooth drilling
- 1/4" Quick change shank



Drill Diameter Sizes (In.)	No. of Hole Sizes	Step Increments (In.)	Step Thickness (In.)	Shank Dia. (In.)	Cat. No.
1/8 to 1/2	13	1/16	1/8	1/4	35-521
1/4 to 7/8	11		1/16		35-522
1/4 to 1-1/8	16		1/16		35-523

Description	Cat. No.
3-Piece Quick Change Step Bit Kit (35-521, 35-522, 35-523)	35-524





## BUL-EYE™ Self Feed Wood Boring Bits

WOOD BORING BITS

Description	Diameter	Entrance Size for Pipe & EMT	Cat.
1 in. Self-Feed Wood Boring Bit	1 in.	1/2 in.	<b>36-250</b>
1-1/8 in. Self-Feed Wood Boring Bit	1-1/8 in.	—	<b>36-251</b>
1-1/4 in. Self-Feed Wood Boring Bit	1-1/4 in.	3/4 in.	<b>36-252</b>
1-3/8 in. Self-Feed Wood Boring Bit	1-3/8 in.	1 in.	<b>36-253</b>
1-1/2 in. Self-Feed Wood Boring Bit	1-1/2 in.	—	<b>36-254</b>
1-3/4 in. Self-Feed Wood Boring Bit	1-3/4 in.	1-1/4 in.	<b>36-255</b>
2 in. Self-Feed Wood Boring Bit	2 in.	1-1/2 in.	<b>36-256</b>
2-1/8 in. Self-Feed Wood Boring Bit	2-1/8 in.	—	<b>36-257</b>
2-1/4 in. Self-Feed Wood Boring Bit	2-1/4 in.	—	<b>36-258</b>
2-9/16 in. Self-Feed Wood Boring Bit	2-9/16 in.	2 in.	<b>36-259</b>
3 in. Self-Feed Wood Boring Bit	3 in.	2-1/2 in.	<b>36-260</b>
3-5/8 in. Self-Feed Wood Boring Bit	3-5/8 in.	3 in.	<b>36-261</b>
4-5/8 in. Self-Feed Wood Boring Bit	4-5/8 in.	4 in.	<b>36-262</b>
5-1/2 in. Extension Bar	—	—	<b>36-273</b>
18 in. Extension Bar	—	—	<b>35-819</b>

## Replacement Lead Screws

- Keeps self-feed bits running fast and true
- Easily replaced with hex wrench providing extended drill life and optimum cost-per-hole value

Description	Qty.	Cat. No.
Small replacement lead screws, fits bit sizes 1 in. - 2-9/16 in. 	3/pack	<b>36-271</b>
Small replacement lead screws, fits bit sizes 3 in. - 4-5/8 in. 	3/pack	<b>36-270</b>

## Extension Bars

- Cuts into hard-to-reach areas
- Fits IDEAL Auger Bits

Description	Cat. No.
5-1/2 in. Extension Bar 	<b>36-273</b>
18 in. Extension Bar	<b>35-819</b>

## Sharpening File

- Keeps durable bits working like new
- High-grade sharpener hones dulled edges quickly and efficiently

Description	Cat. No.
Sharpening File 	<b>36-272</b>

## 6-Piece Kit

Includes five different bit sizes, a 5-1/2 in. extension bar, and a convenient carrying case, giving you everything you need for drilling multiple hole sizes in any wood material.

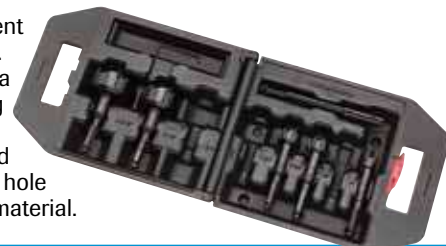

Description	Cat. No.
5-1/2 in. extension bar, 1 in., 1-1/4 in., 1-3/8 in., 2 in., 2-9/16 in. bits	<b>36-266</b>

## 9-Piece Kit

Includes eight different bit sizes, a 5-1/2 in. extension bar, and a convenient carrying case, giving you everything you need for drilling multiple hole sizes in any wood material.

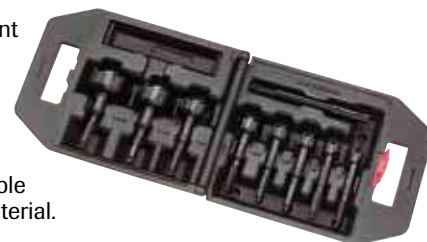

Description	Cat. No.
5-1/2 in. extension bar, 1 in., 1-1/8 in., 1-1/4 in., 1-3/8 in., 1-1/2 in., 1-3/4 in., 2-1/8 in., 2-9/16 in. bits	<b>36-269</b>

Wider precision ground teeth for maximum control

Robust replaceable lead screw with burr-free threads

Twin cutting edges for faster, more balanced drilling and cleaner holes

Precision machined shaft eliminates wobble resulting in true, accurate holes

Black oxide coated, heat treated and hardened for improved durability

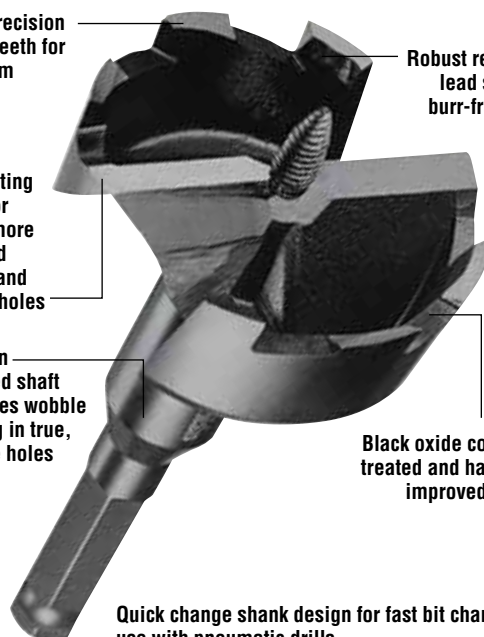

Quick change shank design for fast bit changes and use with pneumatic drills



# TOOLS & SUPPLIES

## IDEAL Cable Tie Catalog Numbering System

**IT - 2 - S - MH - C - 0**

IT	2	S	MH	CC	0
<b>IT = IDEAL Powr-Tie™ Cable Ties</b>	<b>Size</b> Approximate Bundle Diameter for ties	<b>Tensile Strength</b> M = Miniature (18 lbs.) I = Intermediate (40 lbs.) S = Standard (50 lbs.) LH = Light-Heavy Duty (120 lbs.) H = Heavy Duty (175 lbs.) EH = Extra Heavy-Duty (250 lbs.)	<b>Style</b> _ = Standard Tie MH = Mounting ID = Identification MB = Mounting Base LPMB = Low Profile Mounting Base MP = Mounting Pad CCL = Cable Clamp	<b>Qty. Per Package</b> L = 50 C = 100 D = 500 M = 1000	<b>Color</b> _ = Natural 0 = UV Black 8 = Gray 30 = Heat Stabilized Black 35 = Maroon 702 = Halar

CABLE TIES

## Cable-Tie Installation Tools

- Consistent, positive tension
- Flush cut-off leaves no projections to damage nearby wires or components
- Lightweight economy model for smaller jobs
- Standard and heavy-duty models feature rugged construction with comfortable, cushioned grips

Description	Cat. No.
Economy – use w/standard & heavy-duty ties	<b>41-990</b>
Heavy-Duty – use w/standard & heavy-duty ties	<b>41-995</b>



## Identification Ties

- Write-on surface
- Bundle and identify at the same time

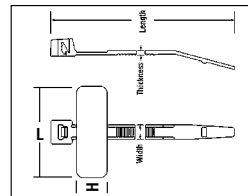

**IT1MID-C**

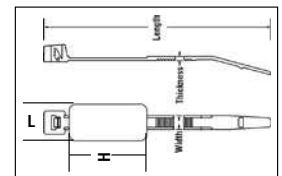

**IT2SID-C & IT4SID-C**

Description	Length	Width	Thickness	Max. Bundle	Tensile Strength	Pad Size (H X L)	Qty./Bag	Cat. No.
Natural Nylon	4.0 in./102mm	.100 in./2.54mm	.044 in./1.12mm	1/16 - 7/8 in.	18 lbs.	5/16 in. x 1 in.	100	<b>IT1MID-C</b>
Natural Nylon	7.8 in./200mm	.181 in./4.59mm	.055 in./1.40mm	1/16 - 1-7/8 in.	50 lbs.	1-1/8 in. x 1/2 in.	100	<b>IT2SID-C</b>

# Screw Mounting Bases - Low Profile

- Perfect for confined space, control panels or other areas where space is limited

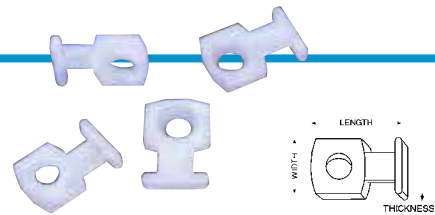

Description	Length	Width	Height	Slot Height	Slot Width	Screw Size	Qty./Bag	Cat. No.
Low Profile Mount	.750 in./19mm	.500 in./12.70mm	.120 in./3.04mm	.062 in./1.57mm	.180 in./4.57mm	No. 8	100	IT1LPMB-C

## Cable Tie Bag

- Keep your cable ties right where you need them, eliminate loss with this convenient easy-to-use bag that clips securely onto your belt
- Includes a bag for 8 in. cable ties and a bag for 11 in. cable ties, easily clip together or used separately
- Elastic cord quickly and easily cinches to keep ties securely in place



Description	Cat. No.
Cable Tie Bag	IT-BAG

## Grommets\*

- Installs instantly! Flexible PVC grommets side slotted 1/16 in. for quick installation
- Snap into holes in electrical boxes, sheet metal, auto firewalls and more
- Prevents steel and other sharp edge chafing of wire insulation or cording
- Black, PVC, flexible, 60 durometer

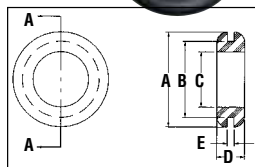

Description	A	B	C	D	E	Qty.	Cat. No.
1/2" Grommets	55/64	.69	1/2	.25	1/16	25	774113
3/4" Grommets	15/64	1.0	3/4	.31	1/16	25	774136

\*Buchanan branded

## Spacer Shims

- Eliminates the need to cut platescrews for "GFCI" decorator devices when installing on tile, marble, etc.
- Supports loose outlets
- Prevents broken face plates
- Snaps over #6, #8, #10 screws

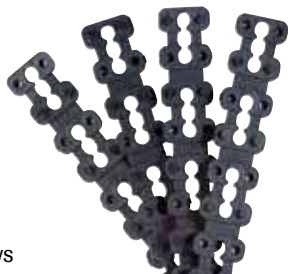

Description	Qty.	Cat. No.
Catepillar	5	772453
Catepillar	500	772451

## Universal Metal Stud Bushings

- Non-metallic stud bushing fits all HOLE configurations you are likely to encounter in pre-punched steel studs
- Long pulls of cable slide smoothly through the bushing, make a difficult job easier
- Protects wire without falling out of the hole

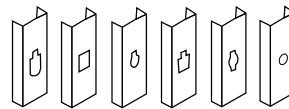
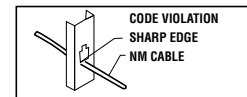

Common hole configurations in metal studs.

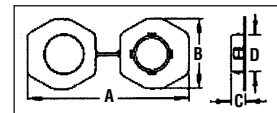

Description	A	B	C	D	Qty.	Cat. No.
Stud Bushing	5.670	2.50	.505	1.30	25	772271

## Flange-Type Plastic Anchor Kits

- Kits include flange-type anchors, slotted/Phillips head screws and masonry bit
- Convenient plastic storage container



Contents	Cat. No.
100 #10-12 x 1 in. Flange-type anchors, 100 #10 x 1-1/4 in. combo-combo-head, sheet-metal screws & 1-1/4 in. masonry bit (carbide-tipped)	90-052

## Flexible Tubing\*

- Flexible polyethylene cuts easily to desired length
- Splits open for neat "bundling" of wiring jobs
- Snaps shut to create a continuous protective cover



Description	Qty.	Cat. No.
3/8 in. Flexible Tubing	10 ft.	772240
1/2 in. Flexible Tubing	7 ft.	772241
1 in. Flexible Tubing	5 ft.	772242

\*Buchanan branded